

Legend

- Full Road Closure
- Parking Lane Closure
- Sidewalk Closure
- Work Area

1 2 3

4

5

6

7

8

9

10

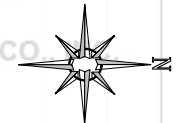
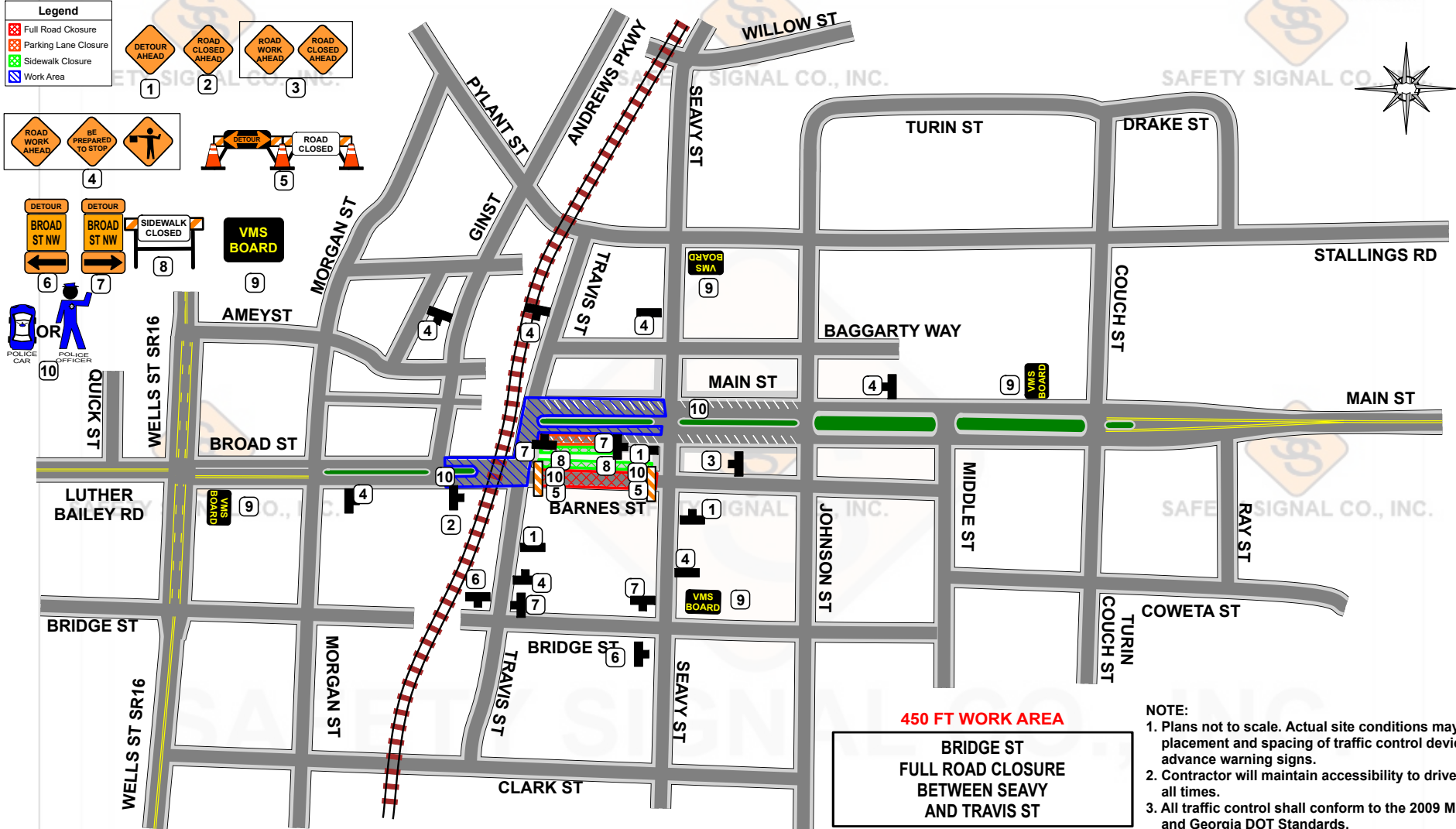

450 FT WORK AREA

**BRIDGE ST
FULL ROAD CLOSURE
BETWEEN SEAVY
AND TRAVIS ST**

630 FT WORK AREA

**MAIN ST
ITC TRAFFIC
BETWEEN GIN ST
AND SEAVY ST**

280 FT WORK AREA

**MAIN ST - EAST CURB
SIDEWALK AND PARKING LANE CLOSURE
BETWEEN TRAVIS ST
AND 33 MAIN ST**

STALWART FILMS, LLC
"THE WALKING DEAD" SEASON 11
 600 Chestlehurst Rd
 Senoia, Georgia 30276
 OFFICE: 678-723-0230 FAX: 678-723-1001

NOTE:

1. Plans not to scale. Actual site conditions may affect placement and spacing of traffic control devices and advance warning signs.
2. Contractor will maintain accessibility to driveway at all times.
3. All traffic control shall conform to the 2009 MUTCD and Georgia DOT Standards.

SAFETY SIGNAL CO., INC.
 P.O. BOX 488
 UNION CITY, GEORGIA 30291
 OFFICE: 770-964-3181
 Drawn by: CT White Date: 07-15-21