

# The Bondsman

\*\*\*\*\* NOTIFICATION OF FILMING \*\*\*\*\*

**TO: Our Senoia Neighbors**  
**FROM: BH Bondsman LLC**  
**DATE: 3/27/2024**  
**RE: Filming in the Area - 398 Plyant Street**

Dear Neighbors,

BH Bondsman LLC is preparing to film scenes for an upcoming show titled "The Bondsman". We will be prepping and filming near 398 Plyant Street beginning on 4/12/2024. Our prep, film, and strike times are as follows:

**Prep: 4/12/2024, 7A-7P - 2 Officers**  
**Shoot: 4/15/2024, 6:30A-2:00P - 7 Officers**  
**Strike: 4/16/2024, 7A-7P 2 Officer**

On prep & strike days we will have a lane closure south-bound on Plyant Street between Johnson St. and Seavy St. between 7A-7P. On our film day we will have a 4-way closure at the intersection of Plyant St., Johnson St., and Turin St. from roughly 6:30A-2:00P. Additionally, we will utilize intermittent traffic control on Seavy St. and at the edge of Plyant St. near Travis St. See attached traffic control plan for reference. We will have Senoia PD with us to ensure a safe filming experience for the community and crew.

Everyone associated with The Bondsman will ensure that this is a positive filming experience within the community. Should you have any questions, please feel free to contact us.

Thank you,

Lenzi Sealy  
Key Assistant Location Manager  
(404) 357-5337  
Lsealy@gmail.com

Juan Espinosa  
Assistant Location Manager  
(678) 608-5670  
jespinosastudio@gmail.com

7 Officers

**STS** Southeastern Traffic Supply, LLC  
 1500 Veterans Memorial Hwy SE  
 Mableton, GA 30126  
 404.989.2441

Date: 3/24/24 Draft: 1  
 Design: Walter W. Thompson (c): 706.254.1919  
 Project: 'The Bondsman'  
 Customer: BH Bondsman, LLC

TRAFFIC CONTROL PLAN DESIGN BY  
 FOURTH WALL INDUSTRIES, LLC

Type of Roads: Urban  
 Speed Limit: 25 mph  
 Traffic Volume: Moderate

DROP: 4/14  
 SHOOT: 4/15  
 PICKUP: 4/16

**Legend**

- Closure Area
- ITC Area
- Buffer Area
- Filming Location
- Officer
- Cone

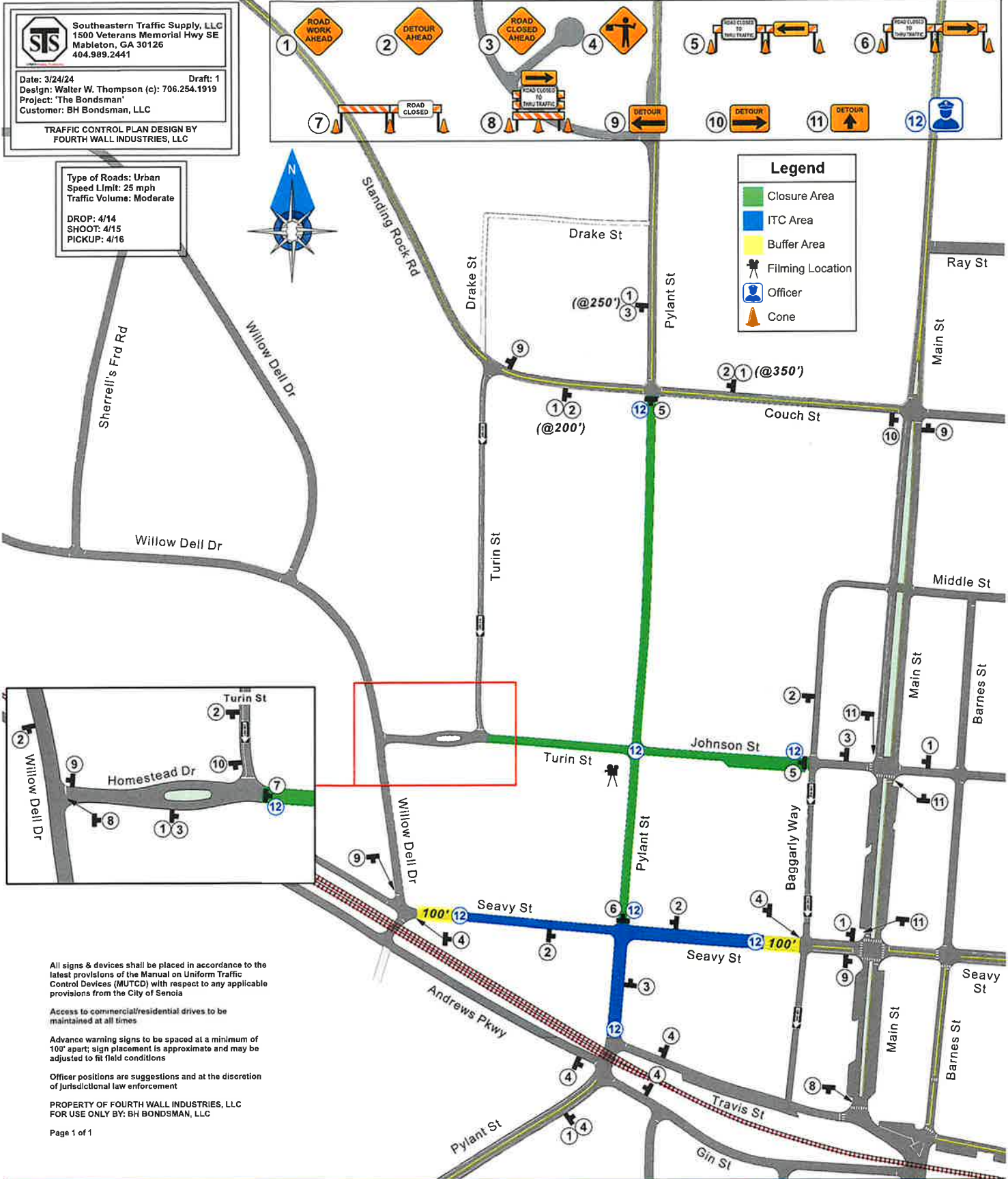

All signs & devices shall be placed in accordance to the latest provisions of the Manual on Uniform Traffic Control Devices (MUTCD) with respect to any applicable provisions from the City of Senoia

Access to commercial/residential drives to be maintained at all times

Advance warning signs to be spaced at a minimum of 100' apart; sign placement is approximate and may be adjusted to fit field conditions

Officer positions are suggestions and at the discretion of jurisdictional law enforcement

PROPERTY OF FOURTH WALL INDUSTRIES, LLC  
 FOR USE ONLY BY: BH BONDSMAN, LLC

**FULL CLOSURE**  
**PYLANT ST:**  
**FROM COUCH ST**  
**TO SEAVY ST**  
**(1,420 FT)**

**FULL CLOSURE**  
**JOHNSON ST:**  
**FROM TURIN ST**  
**TO BAGGARLY WAY**  
**(465 FT)**

**FULL CLOSURE**  
**TURIN ST:**  
**FROM JOHNSON ST**  
**TO HOMESTEAD DR**  
**(410 FT)**

**INT TRAFFIC CONTROL**  
**ALL LANES/ INTERSECTIONS**  
**OF SEAVY ST: B/T**  
**WILLOW DELL DR &**  
**BAGGARLY WAY (800 FT)**

**STS** Southeastern Traffic Supply, LLC  
 1500 Veterans Memorial Hwy SE  
 Mableton, GA 30126  
 404.989.2441

Date: 3/26/24 Draft: 1  
 Design: Walter W. Thompson (c): 706.254.1919  
 Project: 'The Bondsman'  
 Customer: BH Bondsman, LLC

TRAFFIC CONTROL PLAN DESIGN BY  
 FOURTH WALL INDUSTRIES, LLC

Type of Roads: Urban  
 Speed Limit: 25 mph  
 Traffic Volume: Moderate

DROP: 4/11  
 SHOOT: 4/14  
 PICKUP: 4/14



**Legend**

- Work Area
- Prep/Wrap Area
- Officer
- Cone

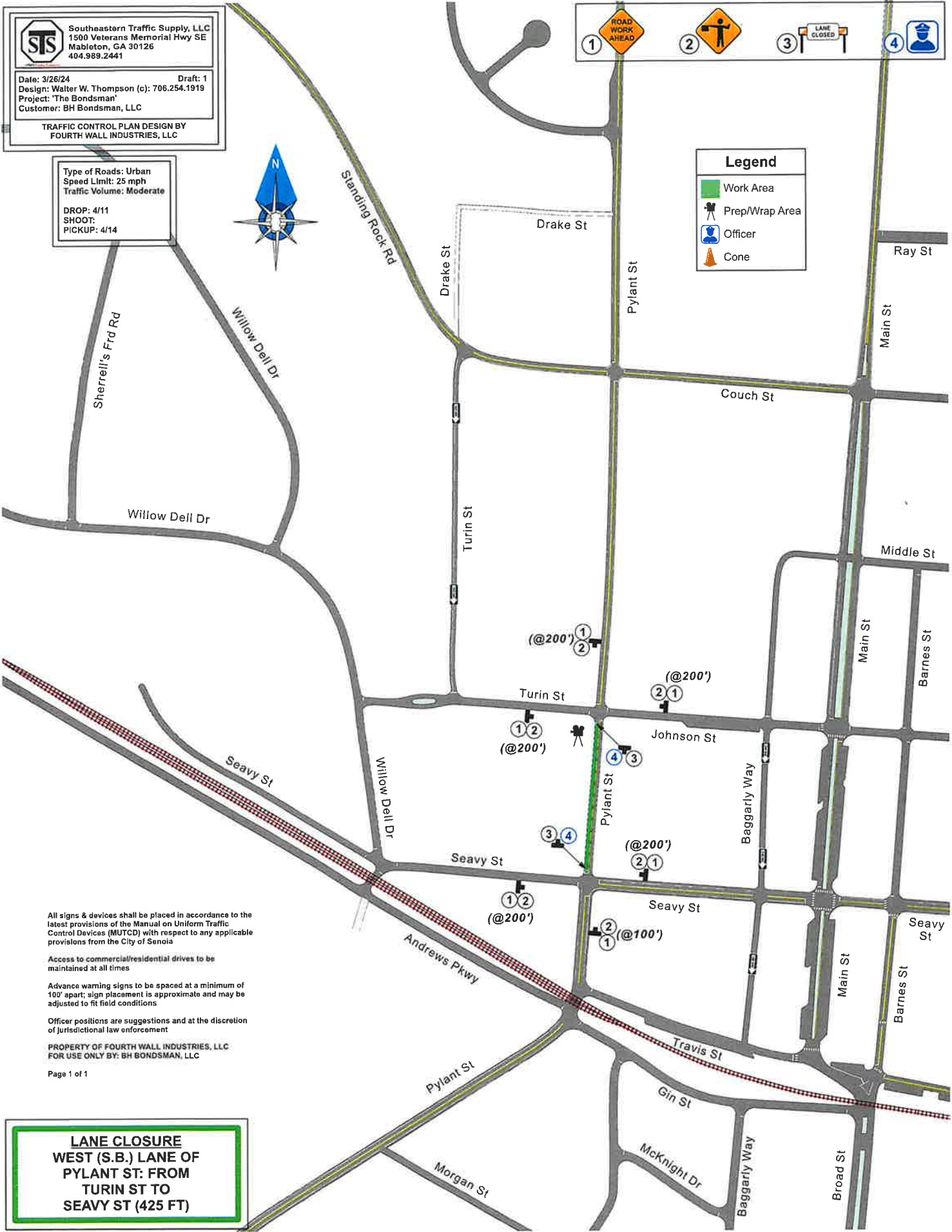

All signs & devices shall be placed in accordance to the latest provisions of the Manual on Uniform Traffic Control Devices (MUTCD) with respect to any applicable provisions from the City of Senoia

Access to commercial/residential drives to be maintained at all times

Advance warning signs to be spaced at a minimum of 100' apart; sign placement is approximate and may be adjusted to fit field conditions

Officer positions are suggestions and at the discretion of jurisdictional law enforcement

PROPERTY OF FOURTH WALL INDUSTRIES, LLC  
 FOR USE ONLY BY: BH BONDSMAN, LLC

**LANE CLOSURE**  
**WEST (S.B.) LANE OF**  
**PYLANT ST: FROM**  
**TURIN ST TO**  
**SEAVY ST (425 FT)**