

The Bondsman

***** NOTIFICATION OF FILMING *****

TO: Residents & Businesses
FROM: BH Bondsman LLC
DATE: 3/27/24
RE: Filming in the Area

Dear Residents and Businesses,

BH Bondsman LLC is preparing to film scenes for an upcoming show titled "The Bondsman". We will be filming exterior and interior scenes at various locations in Senoia, GA. Our prep, film and wrap times are as follow:

Prep: 4/14- 4/15 | 7:00am - 7:00pm each day
Shoot: 4/16 6AM-10PM , 4/17 7AM-11PM ,4/18 8AM-12AM - 2 Officers
Wrap: 4/19-4/20 | 7:00am - 7:00pm each day

We will have security and City of Senoia officers on site during our filming activities. In accordance with The City of Senoia and the Senoia Police Department we are requesting certain closures and traffic control. See below:

FULL CLOSURE: On Vlg W Wy from GA-16 entrance to just before Wings and Things

Everyone associated with BH Bondsman LLC will ensure that this is a positive filming experience. Residents, businesses, and customers will not be prevented from entering nor leaving their homes or businesses. We may ask you to wait for a brief moment while filming but once we're not filming and it is safe, you can continue. Should you have any questions, please feel free to contact us. Thank you!

Sincerely,

Richard Patrick
Key Assistant Location Manager
912-687-2544
richpatricklocations@gmail.com

Tabia Wade
Assistant Location Manager
302-442-2065
tabiaa.wade@gmail.com

2 Officers



| | |
|---|--|
| | Southeastern Traffic Supply, LLC 10000 W. Mineral Pkwy SE Marietta, GA 30066 404.589.2441 |
| | Date: 3/27/24 Draft: 1 Design: Walter W. Thompson (c): 706.254.1919 Project: "The Bondsman" Customer: BH Bondsman, LLC |
| TRAFFIC CONTROL PLAN DESIGN BY FOURTH WALL INDUSTRIES, LLC | |

Type of Roads: Urban
 Speed Limit: 25 mph
 Traffic Volumes: Moderate
 DROP:
 SHOOT: 4:16
 PICKUP:

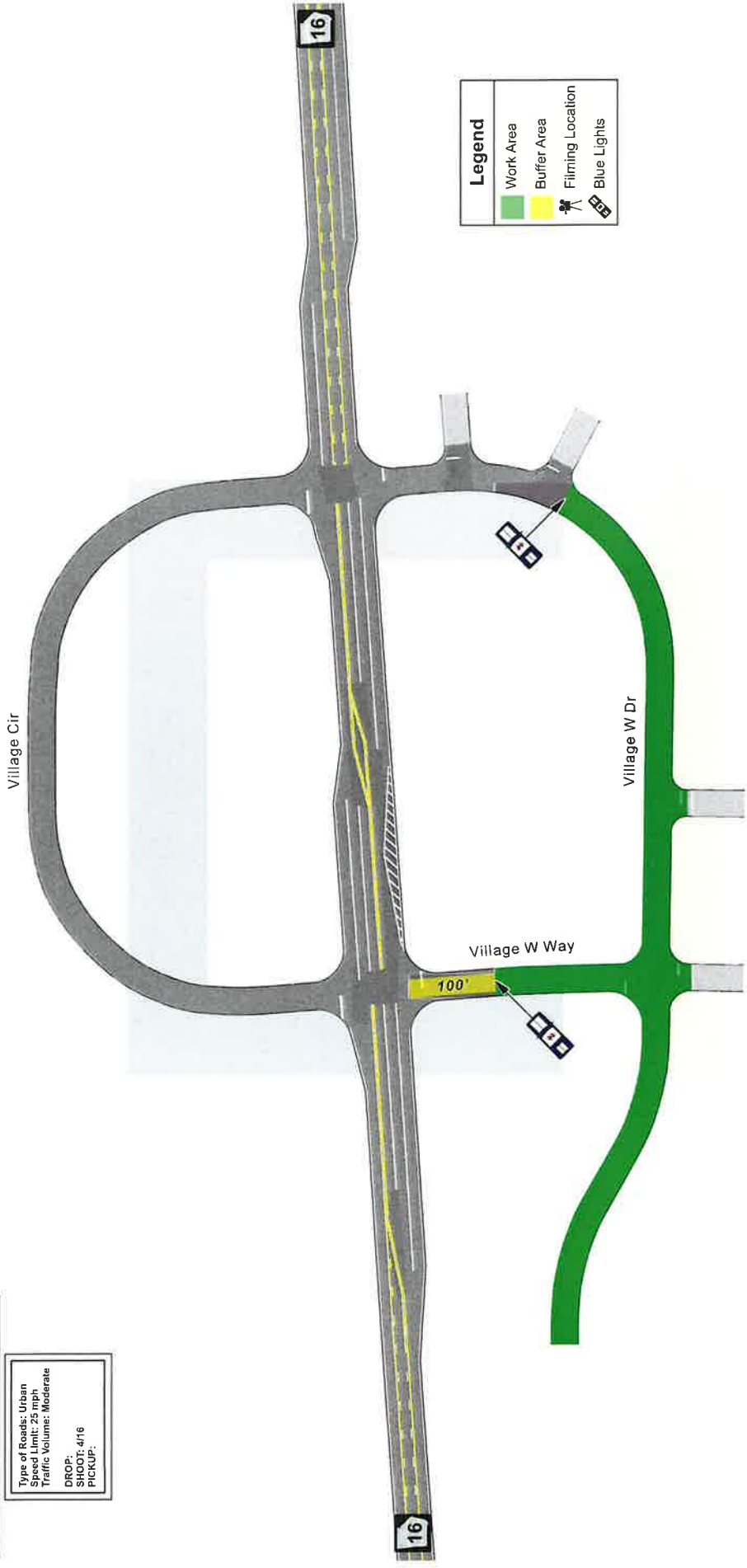

FULL CLOSURE
 VILLAGE W DR: B/T
 SR-16 &
 DEAD END
 (960 FT)

FULL CLOSURE
 VILLAGE W WAY: B/T
 SR-16 &
 VILLAGE W DR
 (150 FT)

All signs & devices shall be placed in accordance to the latest provisions of the Manual on Uniform Traffic Control Devices (MUTCD) and applicable provisions from Coweta County and/or the City of Senola.

Access to commercial/residential drives to be maintained at all times.

Advance warning signs to be spaced at a minimum of 100' apart; sign placement is approximate and may be adjusted to fit field conditions.

Officer positions are suggestions and at the discretion of jurisdictional law enforcement.

PROPERTY OF FOURTH WALL INDUSTRIES, LLC
 FOR USE ONLY BY: BH BONDSMAN, LLC